

**BUILDING REQUIREMENT NOTES:**

- a. COMPLIANCE WITH ALL RELEVANT LAWS AND POLICIES  
i. THE SUBMITTING PERSON, UNDERTAKE AND CONFIRM THAT THE BUILDING PLANS SUBMITTED HEREWITH, COMPLY WITH ALL THE PROVISIONS UNDER THE SARAWAK BUILDINGS ORDINANCE, 1994 AND ITS BY-LAWS (INCLUDING AMENDMENT) AND RELEVANT POLICIES OF THE COUNCIL CONCERNED)
- b. PREVENTION OF DAMPNESS  
COMPLIANCE OF BY-LAW 61 OF THE SBBL 1994
- c. RECESS AND CHASES IN EXTERNAL WALL OR PARTY WALL  
COMPLIANCE OF BY-LAW 65 AND 66 OF THE SBBL 1994
- d. SECURING EXTERNAL PANEL WALL TO REINFORCED CONCRETE FRAME  
COMPLIANCE OF BY-LAW 72 OF THE SBBL 1994
- e. EXTERNAL PANEL WALLS  
COMPLIANCE OF BY-LAW 72 OF THE SBBL 1994
- f. TIMBER BUILDINGS, ROOFS, STAIRCASE AND FLOORS  
COMPLIANCE OF BY-LAW 80,81,82,90,91 OF THE SBBL 1994
- g. SPECIAL PLACE TO HOUSE AIR-CONDITIONING PLANTS / UNITS  
COMPLIANCE OF BY-LAW 110B OF THE SBBL 1994. THE MINIMUM RECESS DEPTH SHALL NOT BE LESS THAN 700mm
- h. BOMBA REQUIREMENTS  
i. THE SUBMITTING PERSON, CONFIRMED THAT ALL THE REQUIREMENTS FORM BOMBA OR THIS PROJECT ARE INDICATED IN THIS BUILDING PLAN AND ARE ALL IN ACCORDANCE WITH THE BOMBA ENDORSED SET OF THE BUILDING PLAN REF. NO. ....DATED.....

**HEALTH REQUIREMENT NOTES:**

- a. WHEEL BINS SHALL BE PROVIDED ON SITE PRIOR TO ISSUANCE OF OCCUPATION PERMIT
- b. ORIGINAL WARRANTY LETTER FROM THE MANUFACTURER TO BE SUBMITTED DURING OCCUPATION PERMIT INSPECTION
- c. ALL MANHOLE COVERS TO BE SEALED WITH BITUMEN COMPOUND OR EQUIVALENT
- d. OUTLET PIPES SHALL BE PROVIDED FOR CONDENSERS OF AIR CONDITIONING UNITS AND SHALL BE DISCHARGED TO CONCRETE DRAINS
- e. PLUMBING FROM FLOOR TO FLOOR CONFORMING TO CODE OF PRACTICE (MS 1228: DESIGN AND INSTALLATION OF SEWERAGE SYSTEM)
- f. INSPECTION OR RODING EYE PROVIDED TO ALL BENDS, JUNCTIONS AND JOINTS
- g. WHEN PERMANENT AIR-CONDITIONING IS INTENDED, THERE SHALL ALSO BE PROVIDED ALTERNATIVE APPROVED MEANS OF VENTILATING THE AIR-CONDITIONED ENCLOSURE, SUCH THAT WITHIN HALF AN HOUR OF THE AIR-CONDITIONING SYSTEM FAILING, NOT LESS THAN THE STIPULATED VOLUME OF FRESH AIR SPECIFIED SHALL BE INTRODUCED INTO THE ENCLOSURE DURING THE PERIOD WHEN THE AIR-CONDITIONING SYSTEM IS NOT FUNCTIONING (BY-LAW 34)
- h. PROVISIONS OF SCHEDULES C OF THE SBO 1994 SHALL APPLY TO BUILDING WHICH ARE MECHANICALLY VENTILATED OR AIR-CONDITIONED (BY-LAW 34(3))

**ENGINEERING REQUIREMENT NOTE:**

- a. THE ARCHITECT / CONTRACTOR / DEVELOPER MUST ENSURE THAT THE CONSTRUCTION WASTE, ETC. ARE REMOVED FROM THE ROAD RESERVE BEFORE THE APPLICATION FOR OCCUPATION PERMIT
- b. ANY DAMAGE TO EXISTING INFRASTRUCTURE LIKE ROADS, DRAINS, KERBS, FOOTPATHS, ETC. ARE TO BE MADE GOOD
- c. TO TAKE MEASURES TO PREVENT SILT FROM DISCHARGING INTO THE EXISTING DRAINS AND CULVERTS

**GENERAL NOTES:**

1. ALL DIMENSIONS AND LEVELS ARE TO BE VERIFIED ON SITE BY MAIN CONTRACTOR BEFORE WORK COMMENCES. ANY DISCREPANCY BETWEEN DRAWINGS OR THAT ON SITE SHOULD BE NOTIFIED TO THE ARCHITECT/ENGINEER IMMEDIATELY FOR CONFIRMATION BEFORE CONSTRUCTION.
2. PROVIDE R.C. STIFFENERS TO ALL 115MM THK BRICKWALL AT NOT MORE THAN 3600MM INTERNAL.
3. PROVIDE R.C. LINTELS OVER DOORS AND WINDOWS WHERE NECESSARY. LINTEL'S LENGTH SHALL BE EXTENDED 150MM ON BOTH SIDES OF OPENING.
4. ALL 115MM THK BRICKWALL TO BE REINFORCED WITH EXMET AT EVERY 4TH COURSE.
5. PROVIDE D.P.C. TO ALL GROUND FLOOR WALLS.
6. R.C. DETAILS AND CALCULATIONS TO BE SUBMITTED BY ENGINEER BEFORE WORK COMMENCE.
7. ALL ROADS AND DRAINAGE LAYOUT WITH INVERT LEVELS TO ENGINEER'S DETAILS.
8. ALL SEWERAGE TO ENGINEER'S DETAILS.
9. THE SITE SHALL BE DEMARCATED AND ALL BOUNDARY DIMENSIONS CHECKED AND VERIFIED BEFORE WORK COMMENCES.
10. ALL DIMENSION ARE IN MILLIMETRES (MM) UNLESS OTHERWISE STATED AND ALL LEVELS ARE IN METRES (M).
11. INSPECTION EYE TO BE PROVIDED TO ALL BENDS AND PIPE JUNCTIONS OF ALL SOIL, WASTE AND VENT PIPES ABOVE GROUND LEVEL.
12. ALL UPVC PIPE JOINTS TO BE SOLVENT WELD.
13. ALL ELECTRICAL WIRING TO BE CONCEALED CONDUITS AND COMPLY WITH BOMBA REQUIREMENTS.
14. ALL MANHOLE COVERS TO BE SEALED WITH BITUMEN COMPOUND AFTER THE INSPECTION OF O.P.

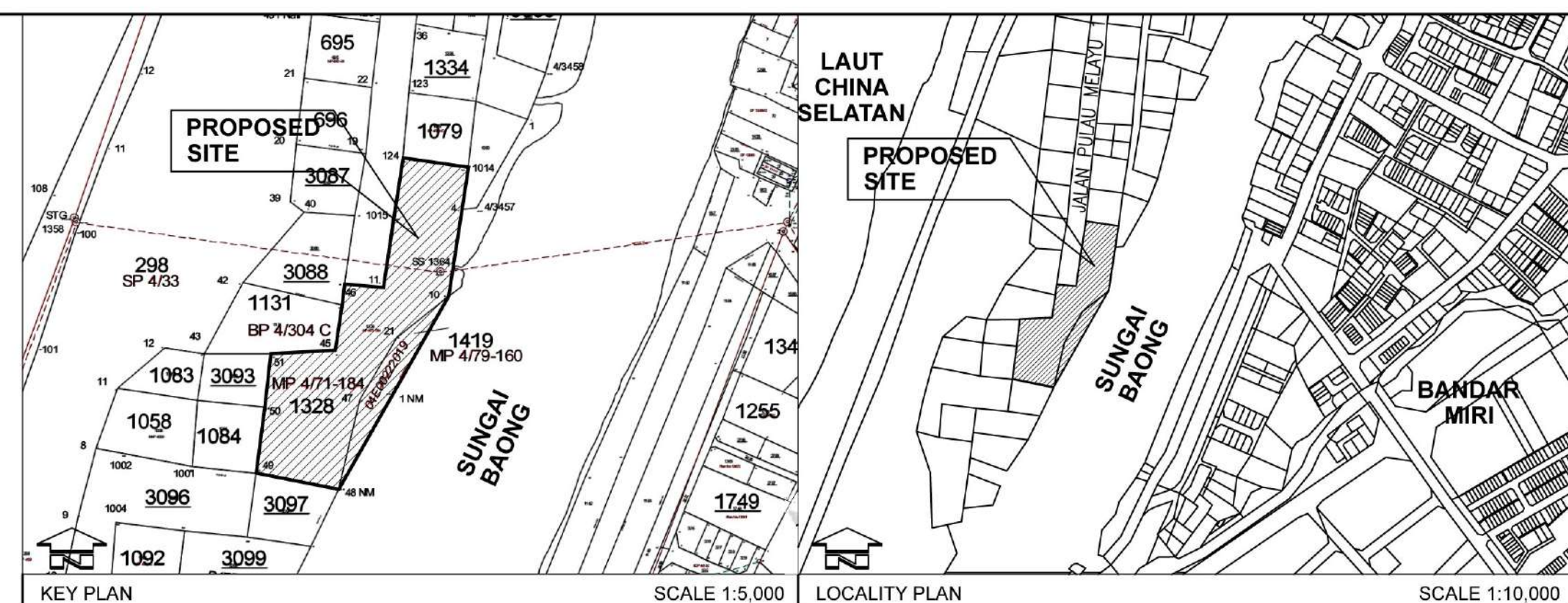
**NOTES :**

- 1) ALL BUILDING MANHOLE INVERT LEVELS REFER TO ENGINEER'S DRAWING
- 2) ROADS, CONC. DRAINS, INVERT LEVELS, PLATFORM LEVEL, WATERMANS, SEWERAGE MAINS & ETC. REFER TO C & S ENGINEERING.
- 3) ALL MAE SERVICES Eg. COLD WATER SUPPLY PIPES & SEWER PIPES ... ETC. REFER TO MAE DRAWING FOR DETAIL

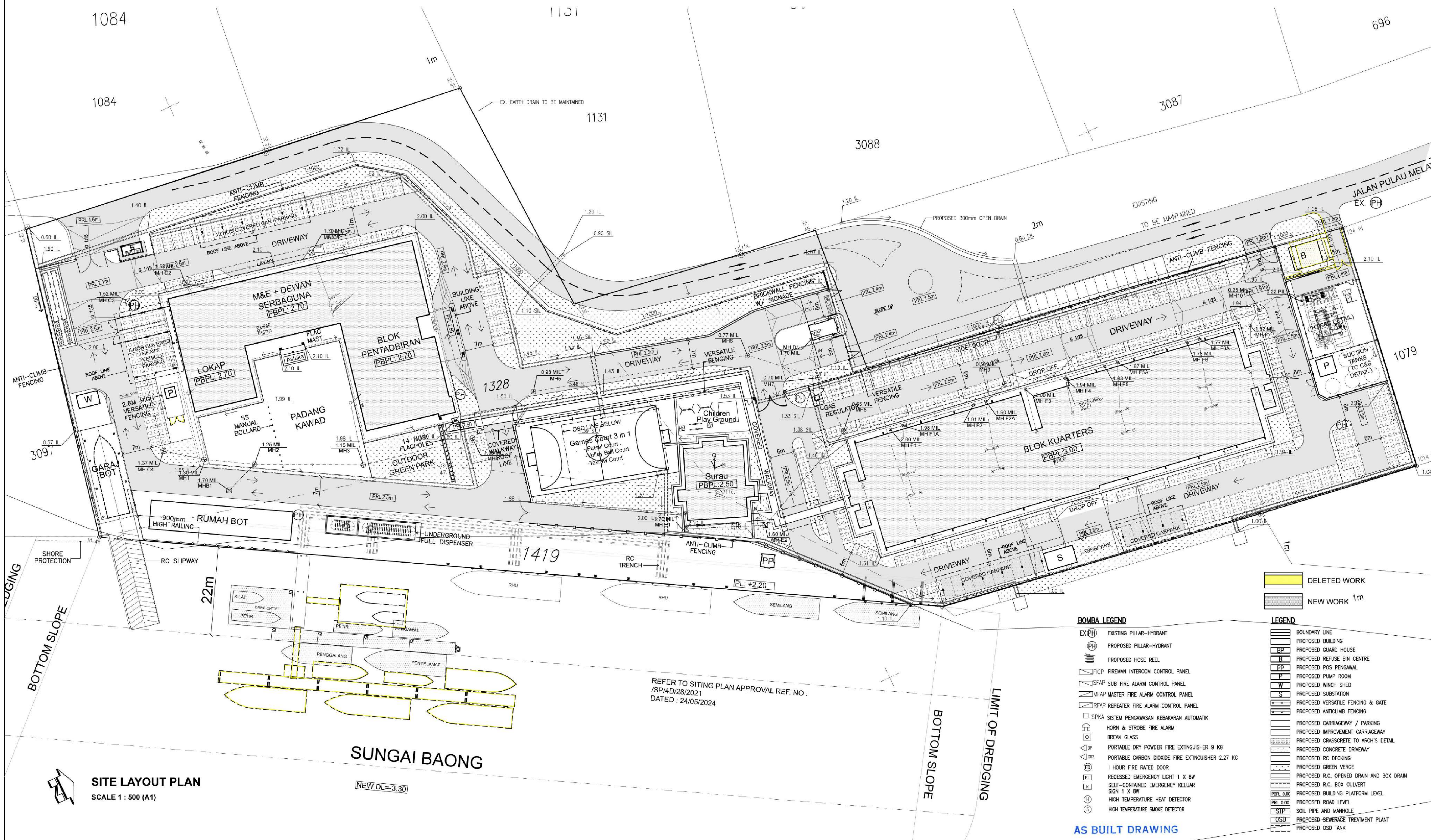
**BOMBA LEGEND**

- EX(PH) EXISTING PILLAR-HYDRANT
- PH PROPOSED PILLAR-HYDRANT
- PROPOSED HOSE REEL
- JFICP FIREMAN INTERCOM CONTROL PANEL
- SFAP SUB FIRE ALARM CONTROL PANEL
- MFAP MASTER FIRE ALARM CONTROL PANEL
- RFAP REPEATER FIRE ALARM CONTROL PANEL
- SPKA SISTEM PENGAMASAN KEBAKARAN AUTOMATIK
- HORN & STROBE FIRE ALARM
- BREAK GLASS
- PORTABLE DRY POWDER FIRE EXTINGUISHER 9 KG
- PORTABLE CARBON DIOXIDE FIRE EXTINGUISHER 2.27 KG
- 1 HOUR FIRE RATED DOOR
- RECESSED EMERGENCY LIGHT 1 X BW
- SELF-CONTAINED EMERGENCY KELUAR SIGN 1 X BW
- HIGH TEMPERATURE HEAT DETECTOR
- HIGH TEMPERATURE SMOKE DETECTOR

**LEGEND**

- BOUNDARY LINE
- PROPOSED BUILDING
- PROPOSED GUARD HOUSE
- PROPOSED REFUSE BIN CENTRE
- PROPOSED POS PENGAMAL
- PROPOSED PUMP ROOM
- PROPOSED WINCH SHED
- PROPOSED SUBSTATION
- PROPOSED VERSATILE FENCING & GATE
- PROPOSED ANTICLIMB FENCING
- PROPOSED CARRIAGEWAY / PARKING
- PROPOSED IMPROVEMENT CARRIAGEWAY
- PROPOSED GRASSCOTTE TO ARCH'S DETAIL
- PROPOSED CONCRETE DRIVEWAY
- PROPOSED RC DECKING
- PROPOSED GREEN VERGE
- PROPOSED R.C. OPENED DRAIN AND BOX DRAIN
- PROPOSED R.C. BOX CULVERT
- PROPOSED BUILDING PLATFORM LEVEL
- PROPOSED ROAD LEVEL
- PROPOSED SOIL PIPE AND MANHOLE
- PROPOSED SEWERAGE TREATMENT PLANT
- PROPOSED OSD TANK

**AS BUILT DRAWING**

BOMBA

L &amp; S

COUNCIL

PROJECT TITLE :

CADANGAN LUKISAN TERBINA (AS-BUILT)  
KEPADA PELAN BANGUNAN YANG TELAH  
DILULUSKAN BAGI PEMBINAAN KOMPLEKS  
AGENCI PENGATKUSAAN MARITIM  
MALAYSIA (APMM) DAN LAIN-LAIN  
KEMUDAHAN, DAERAH MARITIM MIRI DI ATAS  
LOT 1328 DAN 1419, BLOK 7, MIRI  
CONCESSION LAND DISTRICT, JALAN PULAU  
MELAYU 1, MIRI, SARAWAK

APPROVED PLAN NO: MCC/PW-129/2021/46

CLIENT : KEMENTERIAN DALAM NEGERI  
BLOK D1, D2 & D3, KOMPLEKS D,  
PUSAT PENTADBIRAN, KERAJAAN PERSEKUTUAN, 62546 PUTRAJAYA  
TEL: 03-80080000 FAX: 03-88881613 / 03-88881610

SIGNATURE :  
Ar. Chai Long Sen  
No. Pendaftaran LAM : A/C 84

IMPLEMENTATION AGENCY:  
CAWANGAN KEJURUTERAAN INFRASTRUKTUR PENGANGKUTAN  
JABATAN KERJA RAYA (JKR)

END USER:  
AGENCI PENGATKUSAAN MARITIM MALAYSIA (APMM)

ARCHITECT:  
JURUBINA UNIREKA  
SUITE 13.11, KUEH HOCK KUI COMMERCIAL CENTRE,  
LOT 3007, JALAN TUN. AHMAD ZAKI ADRICE,  
93150 KUCHING, SARAWAK  
TEL: 082-418155/415166 FAX: 082-418177  
E-MAIL : jurubina@unireka.com

SIGNATURE :  
Ar. Chai Long Sen  
No. Pendaftaran LAM : A/C 84

DESIGN & BUILD PROPONENT:  
BANGKIT ENERGY & PRO LOGISTIC (EM) SDN. BHD.

C&S ENGINEER :  
JURUTERA PERUNDING WAHBA SDN. BHD.

M&E ENGINEER :  
PERUNDING MALCA SDN. BHD.

QUANTITY SURVEYOR :  
JURUKOS RAHAN SDN. BHD.

DRAWING TITLE :  
SITE PLAN  
LOCALITY PLAN  
KEY PLAN

SCALE : AS SHOWN

DESIGNED : - CHECKED : -

DRAWN : - DATE : NOVEMBER 2020

CAD REF : -

JOB NO. OF/ 5029 DRAWING NO. S/01 REV. 1

☒ COUNCIL SUBMISSION ☐ PRELIMINARY DRAWING ☐ FOR REFERENCE

☒ BOMBA SUBMISSION ☐ FOR CONSTRUCTION

☒ L & S SUBMISSION ☐ FOR TENDER

THIS IS A COPYRIGHT PRINT. ANY DISCREPANCIES IN DIMENSIONS ARE TO BE REFERRED TO THE ARCHITECT IMMEDIATELY